

# TAMARIND

## *Turnkey Villa Collection*

USD 850,000 – USD 1,250,000

# *Tamarind Villas* OVERVIEW

The Tamarind offers seamless single-storey living in 2, 3 and 4-bedroom configurations.

Centred on a generous open-plan kitchen and living space, each villa spills naturally onto a private terrace and pool area, framed by lush tropical landscaping.

Located on the flatlands of Samara Beach, the Tamarind collection places owners at the heart of the resort's active offering – walking distance from the Sports Pavilion, Beach Club, Watersports Centre and Samara Beach Hotel.





# Tamarind Villas GALLERY

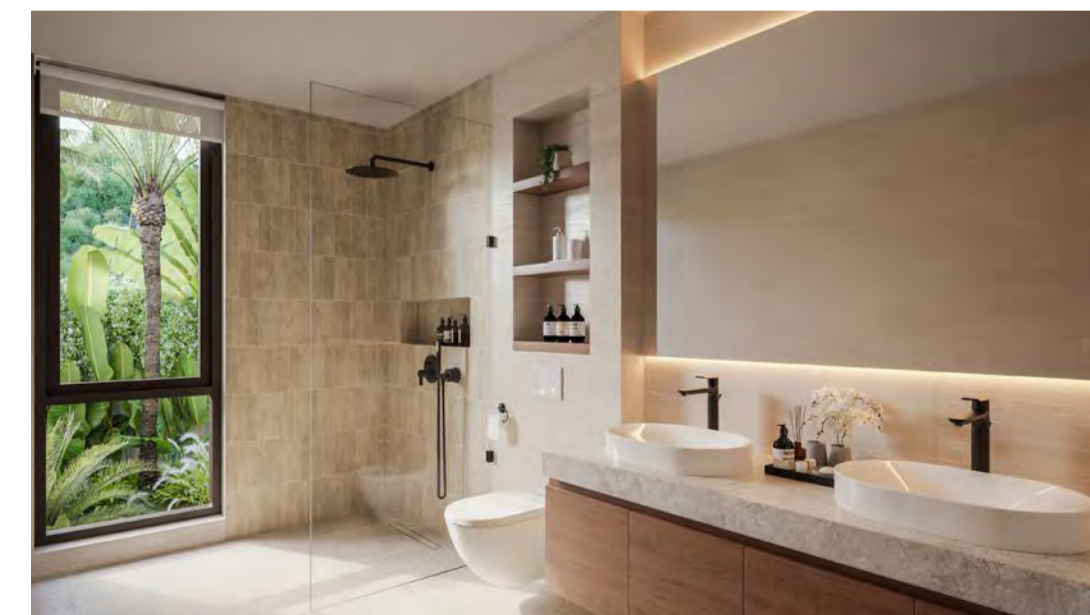



*Tamarind  
Villas*  
GALLERY





# *Tamarind* *2-Bedroom Villa* ROOF

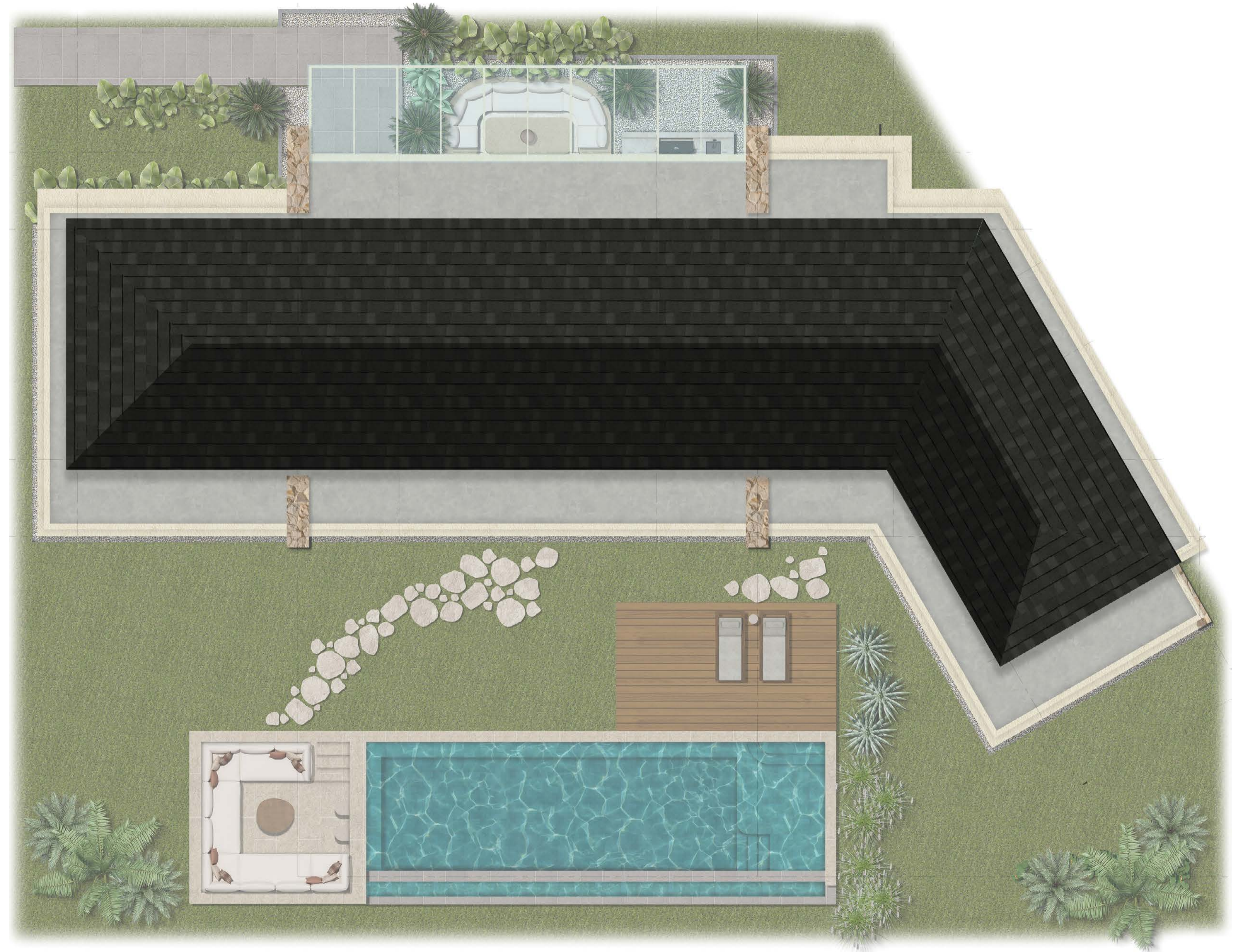

Internal area	206m <sup>2</sup>
External area	247m <sup>2</sup>
Total area	453m <sup>2</sup>
Approx. plot size	882-1,120m <sup>2</sup>

*Tamarind*  
*2-Bedroom Villa*  
**GROUND  
FLOOR**



# *Tamarind* *3-Bedroom Villa* ROOF

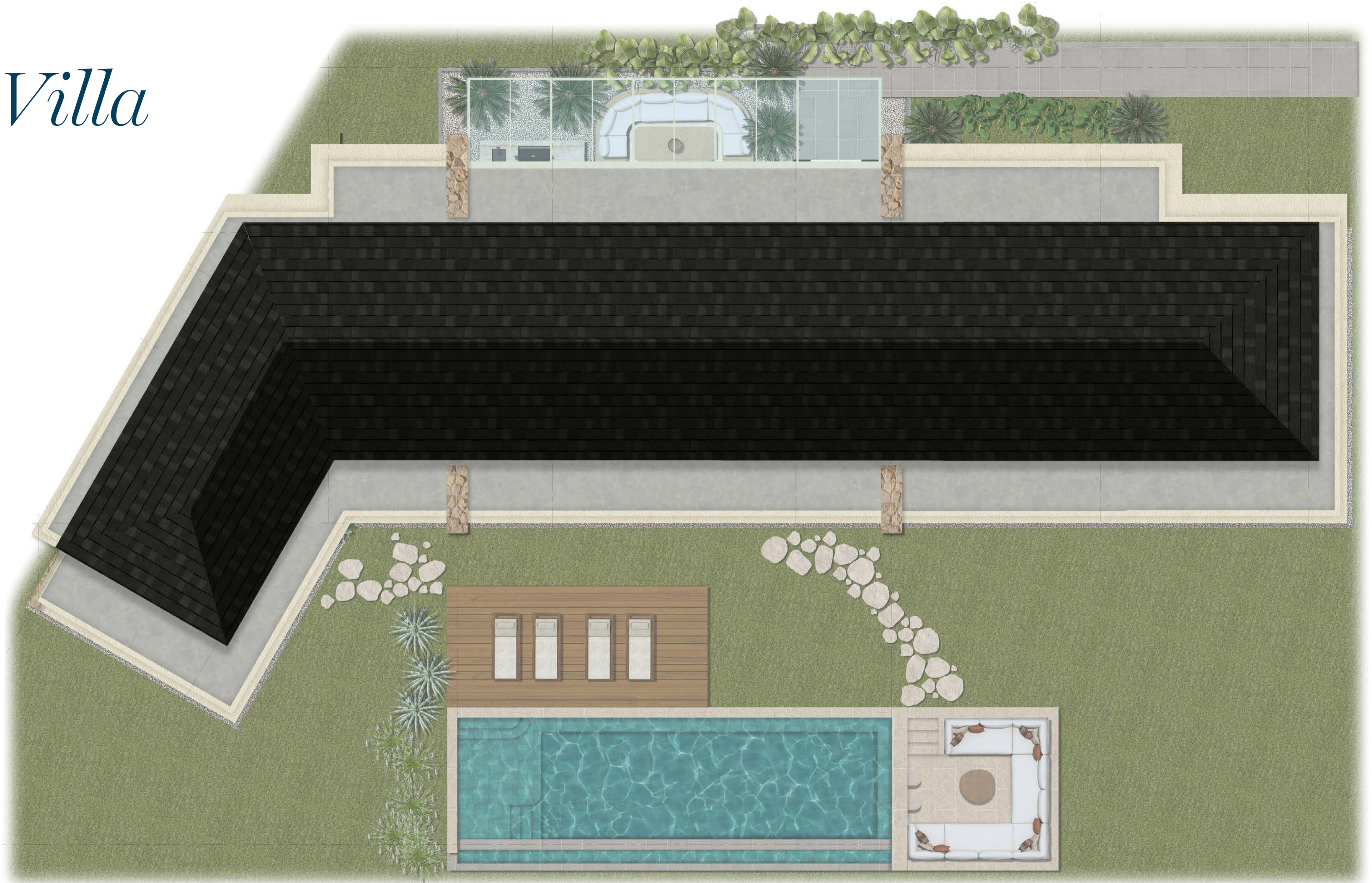

Internal area	266m <sup>2</sup>
External area	254m <sup>2</sup>
Total area	520m <sup>2</sup>
Approx. plot size	1,043-1,464m <sup>2</sup>

# Tamarind 3-Bedroom Villa GROUND FLOOR



# *Tamarind* *4-Bedroom Villa* ROOF

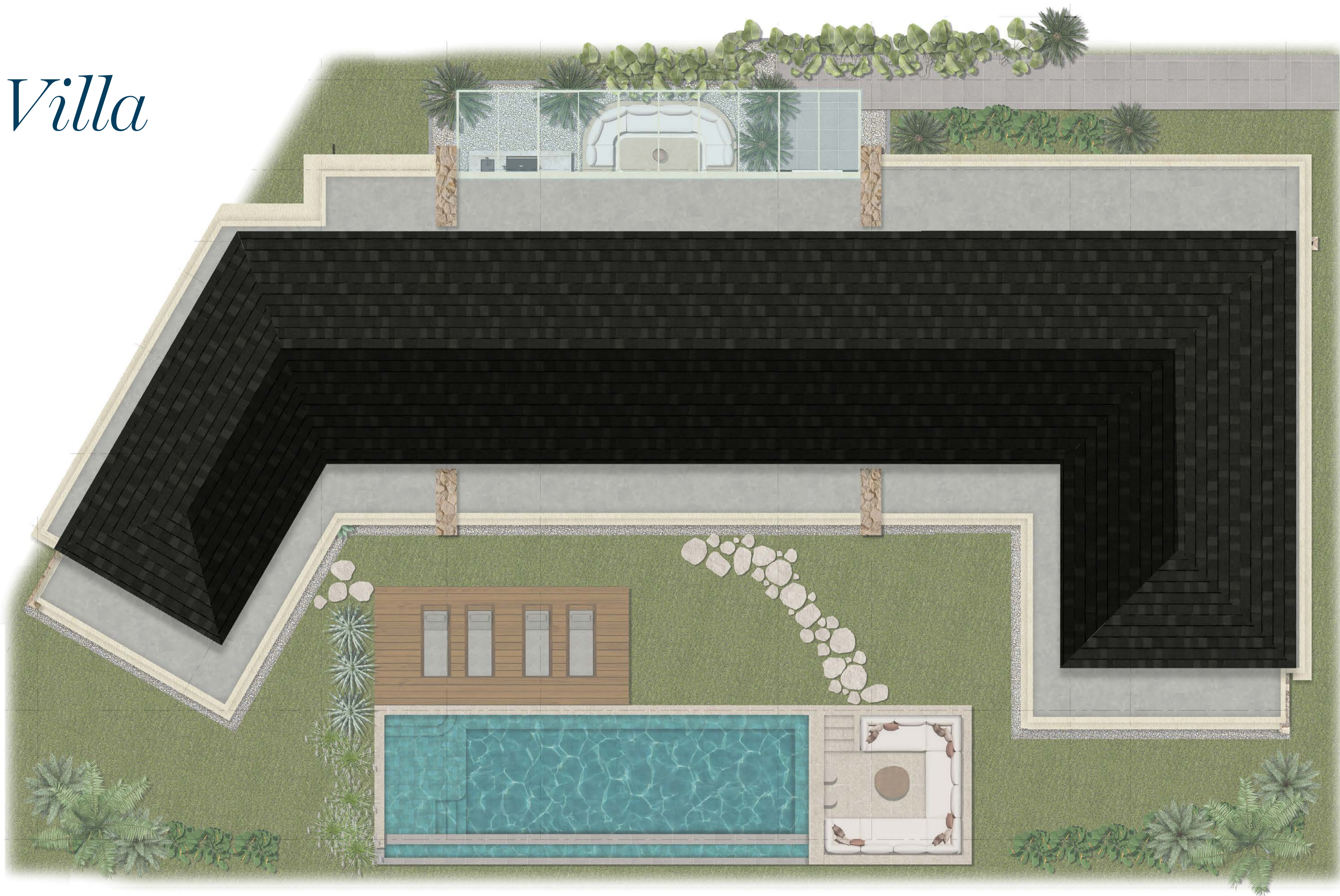

Internal area	316m <sup>2</sup>
External area	277m <sup>2</sup>
Total area	593m <sup>2</sup>
Approx. plot size	1,013-1,514m <sup>2</sup>

# Tamarind 4-Bedroom Villa

## GROUND FLOOR

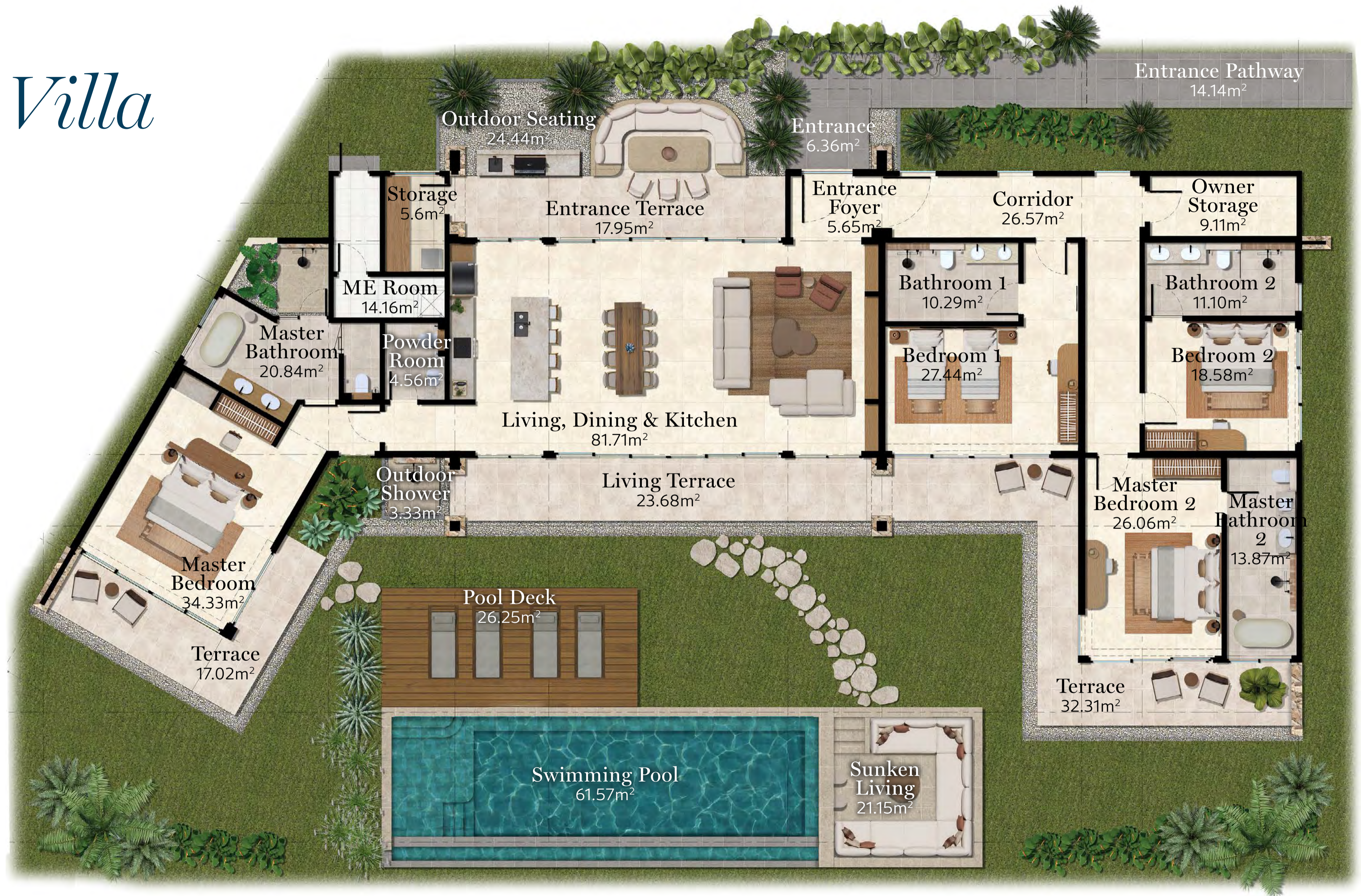

For enquiries, please contact Harmeet Singh Bedi (R070842Z) at  
+65 9030 6807 or [harmeet@ciresg.com](mailto:harmeet@ciresg.com).